

Met-Therm™ - Metcom 7

WARM ROOFING DETAILS

STANDARD INSTALLATION DETAILS, IF INTERNAL SPREAD OF FLAME IS REQUIRED REFER BRANZ TEST REPORT AND OPINION. REQUIRES SIGN OFF FROM FIRE ENGINEER

DETAIL LIST		Revision	Date
D 00 / 13	COVER SHEET		
D 01 / 13	RIDGE WITH PROFILED APEX	1.0	OCT 2024
D 02 / 13	RIDGE WITH NON PROFILED APEX	1.0	OCT 2024
D 03 / 13	SAWTOOTH RIDGE	1.0	OCT 2024
D 04 / 13	INTERNAL GUTTER	1.0	OCT 2024
D 05 / 13	FLUSH EAVE WITH EXTERNAL GUTTER BRACKET	1.0	OCT 2024
D 06 / 13	BARGE WITH PROFILED CLADDING	1.0	OCT 2024
D 07 / 13	PARAPET WITH TRANSVERSE APRON	1.0	OCT 2024
D 08 / 13	PARALLEL APRON	1.0	OCT 2024
D 09 / 13	ROOF STEP	1.0	OCT 2024
D 10 / 13	COLD PIPE PENETRATION	1.0	OCT 2024
D 11 / 13	SKYLIGHT PENETRATION 01	1.0	OCT 2024
D 12 / 13	SKYLIGHT PENETRATION 02	1.0	OCT 2024
D 13 / 13	TYPICAL CROSS SECTION (STAGGERED LAYER)	1.0	OCT 2024

PRE-FINISHED RIDGE CAP FLASHING

STOPENDS TO ROOF CLADDING

METALCRAFT METCOM 7 ROOFING

NOTCHED EDGE DRESSED OVER METCOM 7 RIBS

* METCOM 7 MIN. ROOF PITCH = 3°

FIRE RETARDANT FOAM INFILL (EXPANDING FOAM)

MET-THERM® Batten WITH VENTILATION HOLES

PRO CLIMA TESCON NAIDECK TAPE

UNDERLAY FULLY TAPED REFER NOTE

*PIR BOARD INSULATION REFER NOTE

METALCRAFT METCOM 7 ROOFING REVERSE LAID AND TAPED LAPS

0.55 BMT STEEL FLASHING CONTINUOUS

PRE-FINISHED SELF DRILLING/TAPPING SCREW ON EMBOSSED WASHER

FOAM CLOSURE SEALED TOP AND BOTTOM WITH BOSTIK FIRECAULK SEALANT

PRE-FINISHED SCREW WITH NEOPRENE WASHER

STRUCTURAL DESIGN BY OTHERS
MINIMUM PURLIN WIDTH = 90mm

AS PER MRM CODE OF PRACTICE

CATEGORY A	CATEGORY B	CATEGORY C	CATEGORY D
LOW, MEDIUM OR HIGH WIND ZONES - ALL ROOF PITCHES VERY HIGH AND EXTRA HIGH WIND ZONES WHERE THE PITCH IS EQUAL TO OR GREATER THAN 10°	VERY HIGH WIND ZONES ROOF PITCH <8° EXTRA HIGH WIND ZONES -ALL ROOF PITCHES	SED WIND ZONES UP TO 60 m/s ALL ROOF PITCH	SED WIND ZONES UP TO 68 m/s ALL ROOF PITCH
X MIN. 130mm	MIN. 200mm	MIN. 200mm	MIN. 200mm + BAFFLE (REFER NZ MRM COP)

*FOR PIR BOARD & UNDERLAY OPTIONS REFER TO BUILDING PRODUCT INFORMATION SHEET (BPIS)
WWW.METALCRAFTGROUP.CO.NZ

PRE-FINISHED RIDGE CAP FLASHING

* METCOM 7 MIN. ROOF PITCH = 3°

STOPENDS TO ROOF CLADDING

METALCRAFT METCOM 7
ROOFING

NOTCHED EDGE
DRESSED OVER
METCOM 7 RIBS

FIRE RETARDANT
FOAM INFILL
(EXPANDING FOAM)

MET-THERM® Batten
WITH VENTILATION
HOLES

PRO CLIMA TESCON
NAIDECK TAPE

UNDERLAY FULLY
TAPED REFER NOTE

PRE-FINISHED SELF
DRILLING/TAPPING SCREW
ON EMBOSSED WASHER

FOAM CLOSURE SEALED TOP
AND BOTTOM WITH BOSTIK
FIRECAULK SEALANT

PRE-FINISHED SCREW WITH
NEOPRENE WASHER

STRUCTURAL DESIGN BY OTHERS
MINIMUM PURLIN WIDTH = 90mm

*PIR BOARD INSULATION
REFER NOTE

METALCRAFT
METCOM 7 ROOFING
REVERSE LAID AND
TAPED LAPS

0.55 BMT STEEL
FLASHING
CONTINUOUS

AS PER MRM CODE OF PRACTICE

	CATEGORY A	CATEGORY B	CATEGORY C	CATEGORY D
	LOW, MEDIUM OR HIGH WIND ZONES - ALL ROOF PITCHES VERY HIGH AND EXTRA HIGH WIND ZONES WHERE THE PITCH IS EQUAL TO OR GREATER THAN 10°	VERY HIGH WIND ZONES ROOF PITCH <8° EXTRA HIGH WIND ZONES -ALL ROOF PITCHES	SED WIND ZONES UP TO 60 m/s ALL ROOF PITCH	SED WIND ZONES UP TO 68 m/s ALL ROOF PITCH
X	MIN. 130mm	MIN. 200mm	MIN. 200mm	MIN. 200mm + BAFFLE (REFER NZ MRM COP)

*FOR PIR BOARD & UNDERLAY OPTIONS REFER TO BUILDING PRODUCT INFORMATION SHEET (BPIS)
WWW.METALCRAFTGROUP.CO.NZ

Metalcraft
Roofing
www.metalcraftgroup.co.nz

DISCLAIMER:
These drawings are the copyright of Metalcraft Roofing and all details are to be used for indicative purposes only. The Architect / Designer should consult all of Metalcraft Roofing's MET-THERM® product literature and also the NZMRM code of practice and all relevant building codes. The Architect/ Designer must satisfy themselves that the chosen MET-THERM® system and relevant details are suitable for their specific project. Metalcraft Roofing reserves the right to alter or upgrade these details at any time without prior notice.

RIDGE WITH NON PROFILED APEX
WARM ROOFING DETAILS

Met-Therm™ - Metcom 7

Rev. 1.0

Reference CRMTPMC7

Date OCT 2024

Scale 1 : 2

Sheet **D 02 / 13**

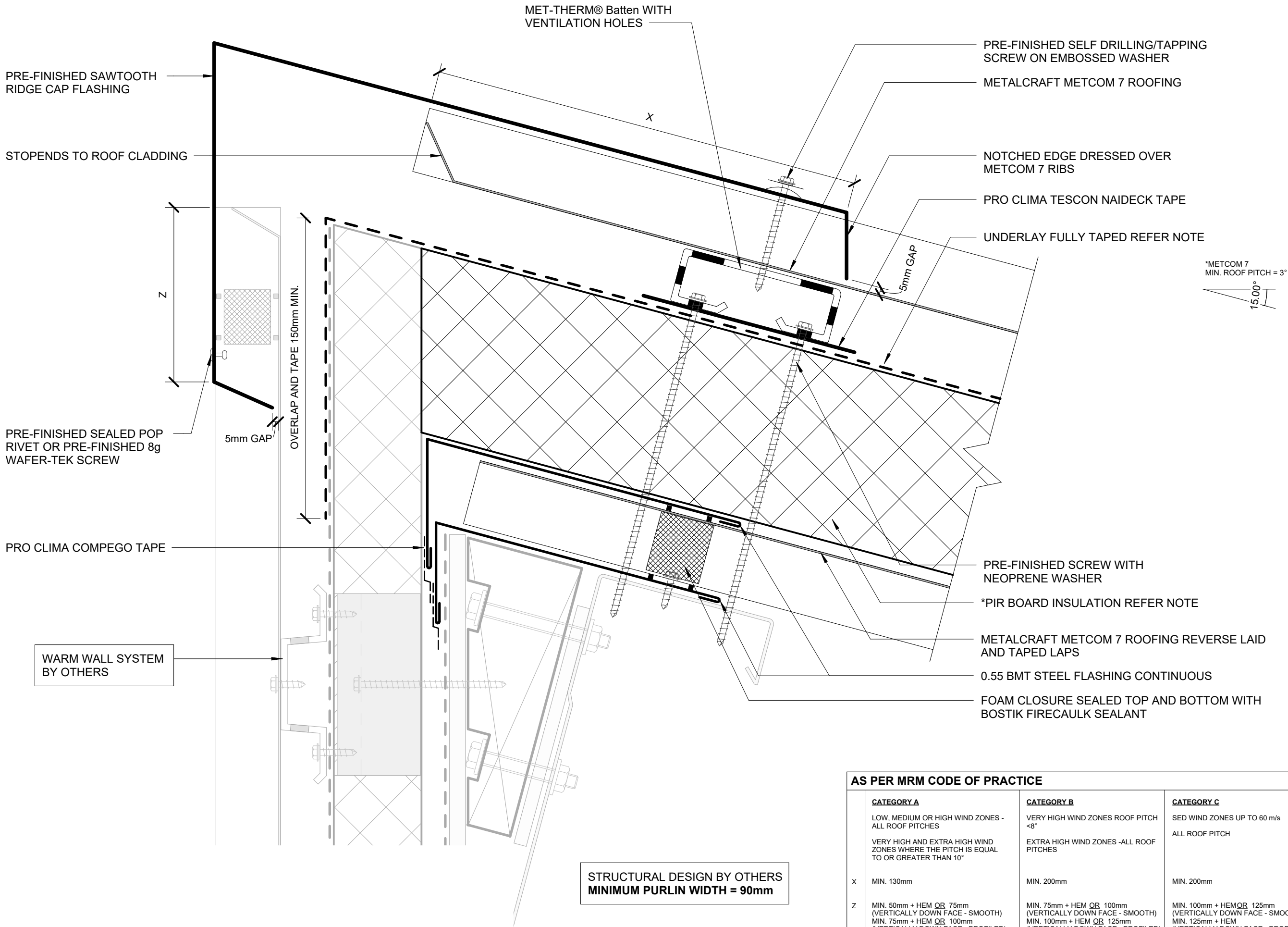

*FOR PIR BOARD & UNDERLAY OPTIONS REFER TO BUILDING PRODUCT INFORMATION SHEET (BPIS)
WWW.METALCRAFTGROUP.CO.NZ

DISCLAIMER:
These drawings are the copyright of Metalcraft Roofing and all details are to be used for indicative purposes only. The Architect / Designer should consult all of Metalcraft Roofing's MET-THERM® product literature and also the NZMRM code of practice and all relevant building codes. The Architect/ Designer must satisfy themselves that the chosen MET-THERM® system and relevant details are suitable for their specific project. Metalcraft Roofing reserves the right to alter or upgrade these details at any time without prior notice.

AS PER MRM CODE OF PRACTICE			
	CATEGORY A	CATEGORY B	CATEGORY C
	LOW, MEDIUM OR HIGH WIND ZONES - ALL ROOF PITCHES VERY HIGH AND EXTRA HIGH WIND ZONES WHERE THE PITCH IS EQUAL TO OR GREATER THAN 10°	VERY HIGH WIND ZONES ROOF PITCH <8° EXTRA HIGH WIND ZONES -ALL ROOF PITCHES	SED WIND ZONES UP TO 60 m/s ALL ROOF PITCH
X	MIN. 130mm	MIN. 200mm	MIN. 200mm
Z	MIN. 50mm + HEM QR 75mm (VERTICALLY DOWN FACE - SMOOTH) MIN. 75mm + HEM QR 100mm (VERTICALLY DOWN FACE - PROFILED)	MIN. 75mm + HEM QR 100mm (VERTICALLY DOWN FACE - SMOOTH) MIN. 100mm + HEM QR 125mm (VERTICALLY DOWN FACE - PROFILED)	MIN. 100mm + HEMQR 125mm (VERTICALLY DOWN FACE - SMOOTH) MIN. 125mm + HEM (VERTICALLY DOWN FACE - PROFILED)
			CATEGORY D
			SED WIND ZONES UP TO 68 m/s ALL ROOF PITCH
			MIN. 200mm + BAFFLE (REFER NZ MRM COP) MIN. 100mm + HEMQR 125mm (VERTICALLY DOWN FACE - SMOOTH) MIN. 125mm + HEM (VERTICALLY DOWN FACE - PROFILED)

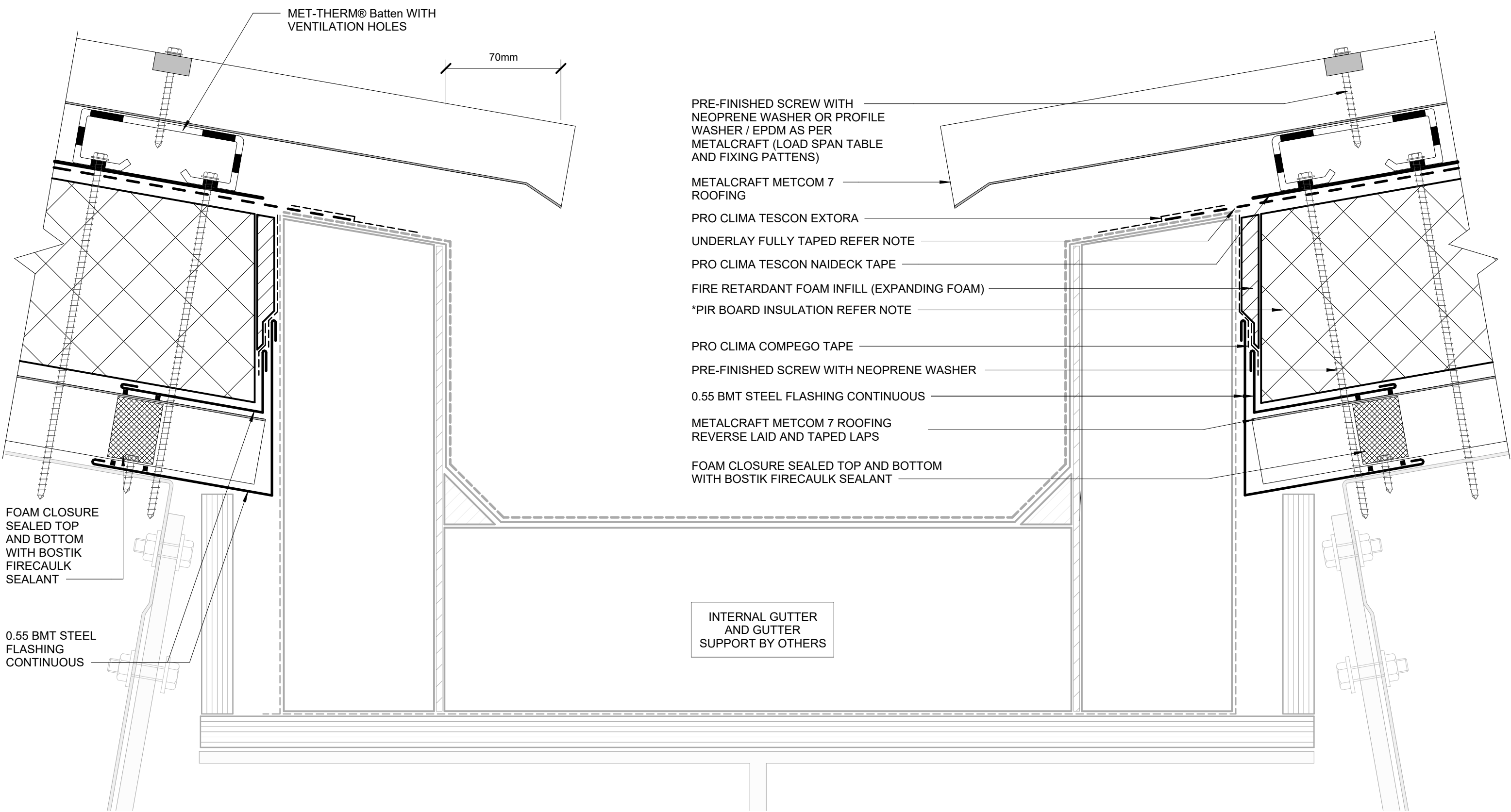

*FOR PIR BOARD & UNDERLAY OPTIONS REFER TO BUILDING PRODUCT INFORMATION SHEET (BPIS)
WWW.METALCRAFTGROUP.CO.NZ

DISCLAIMER:
These drawings are the copyright of Metalcraft Roofing and all details are to be used for indicative purposes only. The Architect / Designer should consult all of Metalcraft Roofing's MET-THERM® product literature and also the NZMRM code of practice and all relevant building codes. The Architect/ Designer must satisfy themselves that the chosen MET-THERM® system and relevant details are suitable for their specific project. Metalcraft Roofing reserves the right to alter or upgrade these details at any time without prior notice.

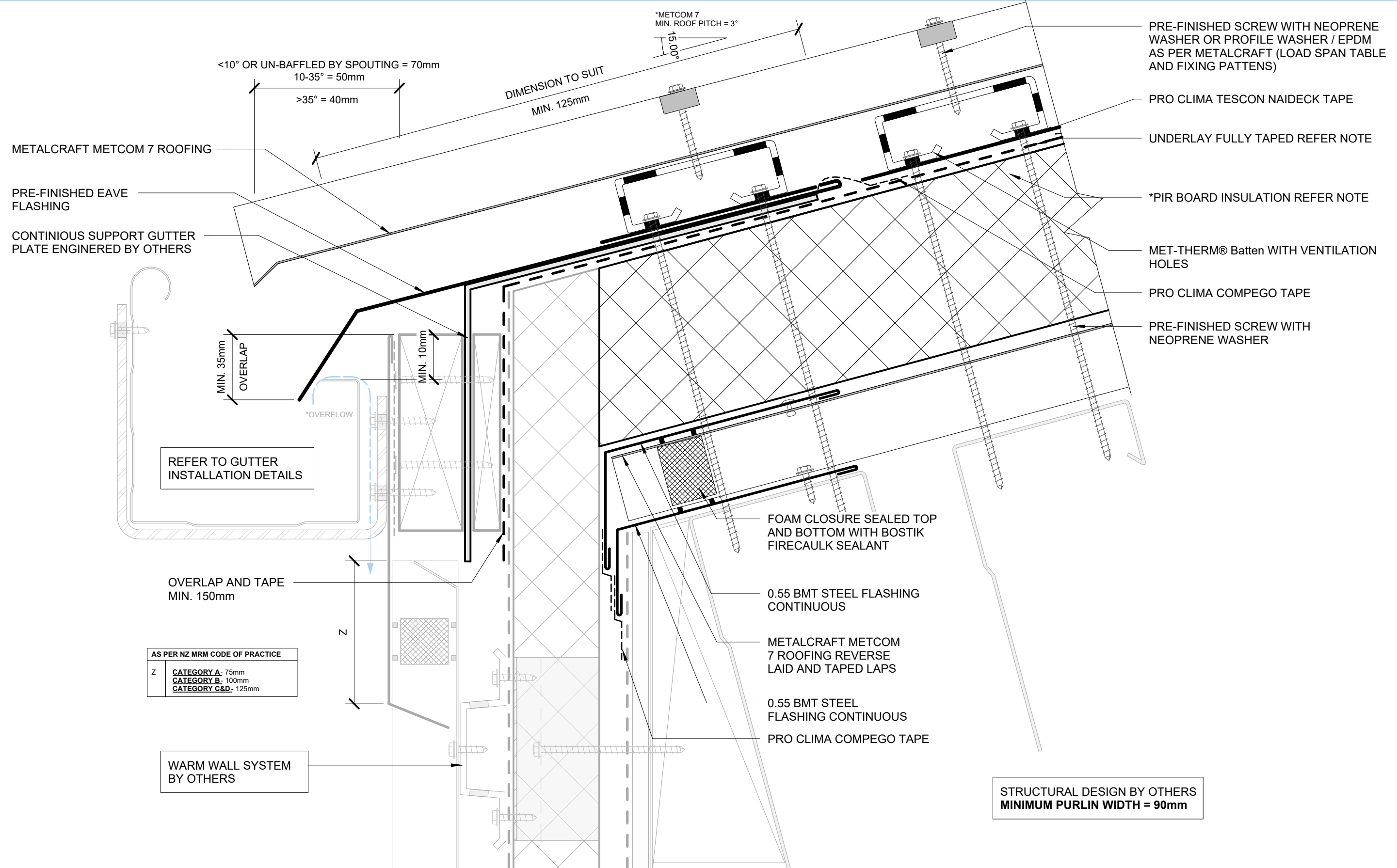

*FOR PIR BOARD & UNDERLAY OPTIONS REFER TO BUILDING PRODUCT INFORMATION SHEET (BPIS)
WWW.METALCRAFTGROUP.CO.NZ

Metalcraft
Roofing
www.metalcraftgroup.co.nz

DISCLAIMER:
These drawings are the copyright of Metalcraft Roofing and all details are to be used for indicative purposes only. The Architect / Designer should consult all of Metalcraft Roofing's MET-THERM® product literature and also the NZMRM code of practice and all relevant building codes. The Architect/ Designer must satisfy themselves that the chosen MET-THERM® system and relevant details are suitable for their specific project. Metalcraft Roofing reserves the right to alter or upgrade these details at any time without prior notice.

FLUSH EAVE WITH EXTERNAL GUTTER BRACKET

Met-Therm™ - Metcom 7

Rev. 1.0

WARM ROOFING DETAILS

Reference CRMTPMC7

Date OCT 2024

Scale 1 : 2

Sheet **D 05 / 13**

UNDERSOAKER
FLASHING REQUIRED
FOR NZ MRM COP
CATEGORY D ONLY

PRE-FINISHED
BARGE FLASHING
PRO CLIMA TESCON
NAIDECK TAPE

PRE-FINISHED
SEALED POP RIVET
OR PRE-FINISHED 8g
WAFFER-TEK SCREW

0.55 BMT SEALED STEEL
FLASHING CONTINUOUS

PRO CLIMA COMPEGO TAPE

PRE-FINISHED SCREW
WITH NEOPRENE WASHER

WARM WALL SYSTEM
BY OTHERS

PRE-FINISHED SELF DRILLING/TAPPING
SCREW ON EMBOSSED WASHER

PRE-FINISHED SCREW WITH NEOPRENE
WASHER OR PROFILE WASHER / EPDM
AS PER METALCRAFT (LOAD SPAN TABLE
AND FIXING PATTERNS)

METALCRAFT METCOM 7 ROOFING

MET-THERM® Batten WITH
VENTILATION HOLES

UNDERLAY FULLY TAPED REFER
NOTE

*PIR BOARD INSULATION REFER NOTE

METALCRAFT METCOM 7 ROOFING
REVERSE LAID AND TAPED LAPS

STRUCTURAL DESIGN BY OTHERS
MINIMUM PURLIN WIDTH = 90mm

AS PER MRM CODE OF PRACTICE

	CATEGORY A	CATEGORY B	CATEGORY C	CATEGORY D
	LOW, MEDIUM OR HIGH WIND ZONES - ALL ROOF PITCHES VERY HIGH AND EXTRA HIGH WIND ZONES WHERE THE PITCH IS EQUAL TO OR GREATER THAN 10°	VERY HIGH WIND ZONES ROOF PITCH <8° EXTRA HIGH WIND ZONES -ALL ROOF PITCHES	SED WIND ZONES UP TO 60 m/s ALL ROOF PITCH	SED WIND ZONES UP TO 68 m/s ALL ROOF PITCH
X	TRAPEZOIDAL & TRAY: ONE RIB CORRUGATE: 2 CORRUGATIONS	TRAPEZOIDAL & TRAY: TWO RIBS (20mm - 34mm)* ONE RIB (>34mm)* CORRUGATE: 2 CORRUGATIONS	TRAPEZOIDAL & TRAY: TWO RIBS (20mm - 34mm)* ONE RIB (>34mm)* CORRUGATE: 3 CORRUGATIONS	TRAPEZOIDAL & TRAY: TWO RIBS (20mm - 34mm)* + UNDERSOAKER ONE RIB (>34mm)* + UNDERSOAKER CORRUGATE: 2 CORRUGATIONS + UNDERSOAKER
Z	MIN. 50mm (VERTICALLY DOWN FACE - SMOOTH) MIN. 75mm (VERTICALLY DOWN FACE - PROFILED)	MIN. 75mm (VERTICALLY DOWN FACE - SMOOTH) MIN. 100mm (VERTICALLY DOWN FACE - PROFILED)	MIN. 75mm (VERTICALLY DOWN FACE - SMOOTH) MIN. 125mm (VERTICALLY DOWN FACE - PROFILED)	MIN. 75mm (VERTICALLY DOWN FACE - SMOOTH) MIN. 125mm (VERTICALLY DOWN FACE - PROFILED)
	* RIB HEIGHT OF PROFILE OR TURNUP			

*FOR PIR BOARD & UNDERLAY OPTIONS REFER TO BUILDING PRODUCT INFORMATION SHEET (BPIS)
WWW.METALCRAFTGROUP.CO.NZ

AS PER MRM CODE OF PRACTICE

	CATEGORY A	CATEGORY B	CATEGORY C	CATEGORY D
	LOW, MEDIUM OR HIGH WIND ZONES - ALL ROOF PITCHES VERY HIGH AND EXTRA HIGH WIND ZONES WHERE THE PITCH IS EQUAL TO OR GREATER THAN 10°	VERY HIGH WIND ZONES ROOF PITCH <8° EXTRA HIGH WIND ZONES -ALL ROOF PITCHES	SED WIND ZONES UP TO 60 m/s ALL ROOF PITCH	SED WIND ZONES UP TO 68 m/s ALL ROOF PITCH
G	25mm	25mm	25mm	25mm
N	MIN. 50mm + HEM OR 75mm (VERTICALLY UP FACE - SMOOTH) MIN. 75mm + HEM OR 100mm (VERTICALLY UP FACE - PROFILED)	MIN. 75mm + HEM OR 100mm (VERTICALLY UP FACE - SMOOTH) MIN. 100mm + HEM OR 125mm (VERTICALLY UP FACE - PROFILED)	MIN. 100mm + HEM OR 125mm (VERTICALLY UP FACE - SMOOTH) MIN. 125mm + HEM (VERTICALLY UP FACE - PROFILED)	MIN. 100mm + HEM OR 125mm (VERTICALLY UP FACE - SMOOTH) MIN. 125mm + HEM (VERTICALLY UP FACE - PROFILED)
X	MIN. 130mm	MIN. 200mm	MIN. 200mm + BAFFLE (REFER NZ MRM COP)	MIN. 200mm + BAFFLE (REFER NZ MRM COP)

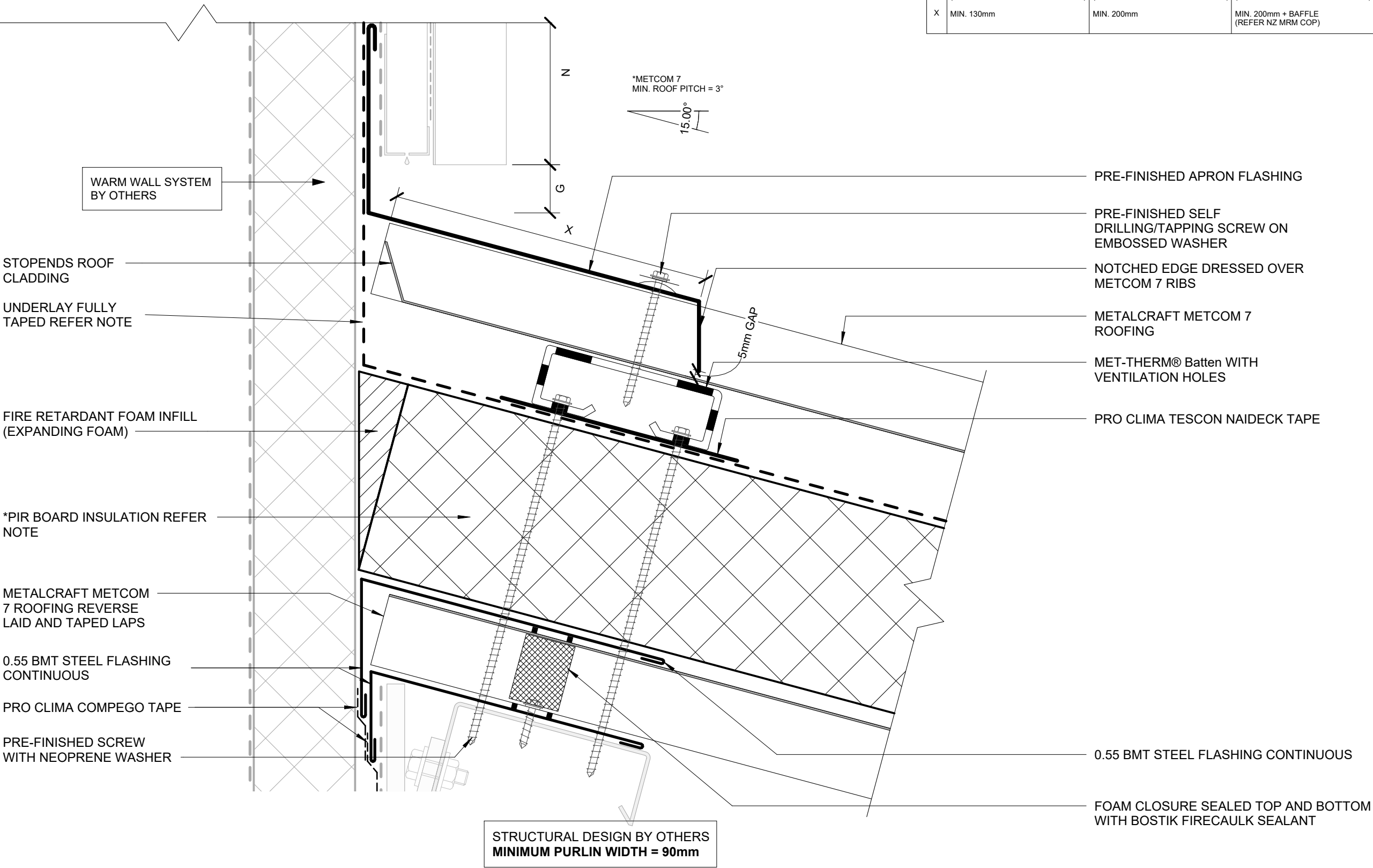

*FOR PIR BOARD & UNDERLAY OPTIONS REFER TO BUILDING PRODUCT INFORMATION SHEET (BPIS)
WWW.METALCRAFTGROUP.CO.NZ

AS PER MRM CODE OF PRACTICE

	CATEGORY A	CATEGORY B	CATEGORY C	CATEGORY D
	LOW, MEDIUM OR HIGH WIND ZONES - ALL ROOF PITCHES VERY HIGH AND EXTRA HIGH WIND ZONES WHERE THE PITCH IS EQUAL TO OR GREATER THAN 10°	VERY HIGH WIND ZONES ROOF PITCH <8° EXTRA HIGH WIND ZONES -ALL ROOF PITCHES	SED WIND ZONES UP TO 60 m/s ALL ROOF PITCH	SED WIND ZONES UP TO 68 m/s ALL ROOF PITCH
M	TRAPEZOIDAL & TRAY: ONE RIB CORRUGATE: 2 CORRUGATIONS	TRAPEZOIDAL & TRAY: TWO RIBS (20mm - 34mm)* ONE RIB (>34mm)* CORRUGATE: 2 CORRUGATIONS	TRAPEZOIDAL & TRAY: TWO RIBS (20mm - 34mm)* ONE RIB (>34mm)* CORRUGATE: 3 CORRUGATIONS	TRAPEZOIDAL & TRAY: TWO RIBS (20mm - 34mm)* + UNDERSOAKER ONE RIB (>34mm)* + UNDERSOAKER CORRUGATE: 2 CORRUGATIONS + UNDERSOAKER
N	MIN. 50mm + HEM OR 75mm (VERTICALLY UP FACE - SMOOTH) MIN. 75mm + HEM OR 100mm (VERTICALLY UP FACE - PROFILED)	MIN. 75mm + HEM OR 100mm (VERTICALLY UP FACE - SMOOTH) MIN. 100mm + HEM OR 125mm (VERTICALLY UP FACE - PROFILED)	MIN. 100mm + HEM OR 125mm (VERTICALLY UP FACE - SMOOTH) MIN. 125mm + HEM (VERTICALLY UP FACE - PROFILED)	MIN. 100mm + HEM OR 125mm (VERTICALLY UP FACE - SMOOTH) MIN. 125mm + HEM (VERTICALLY UP FACE - PROFILED)
* RIB HEIGHT OF PROFILE OR TURNUP				

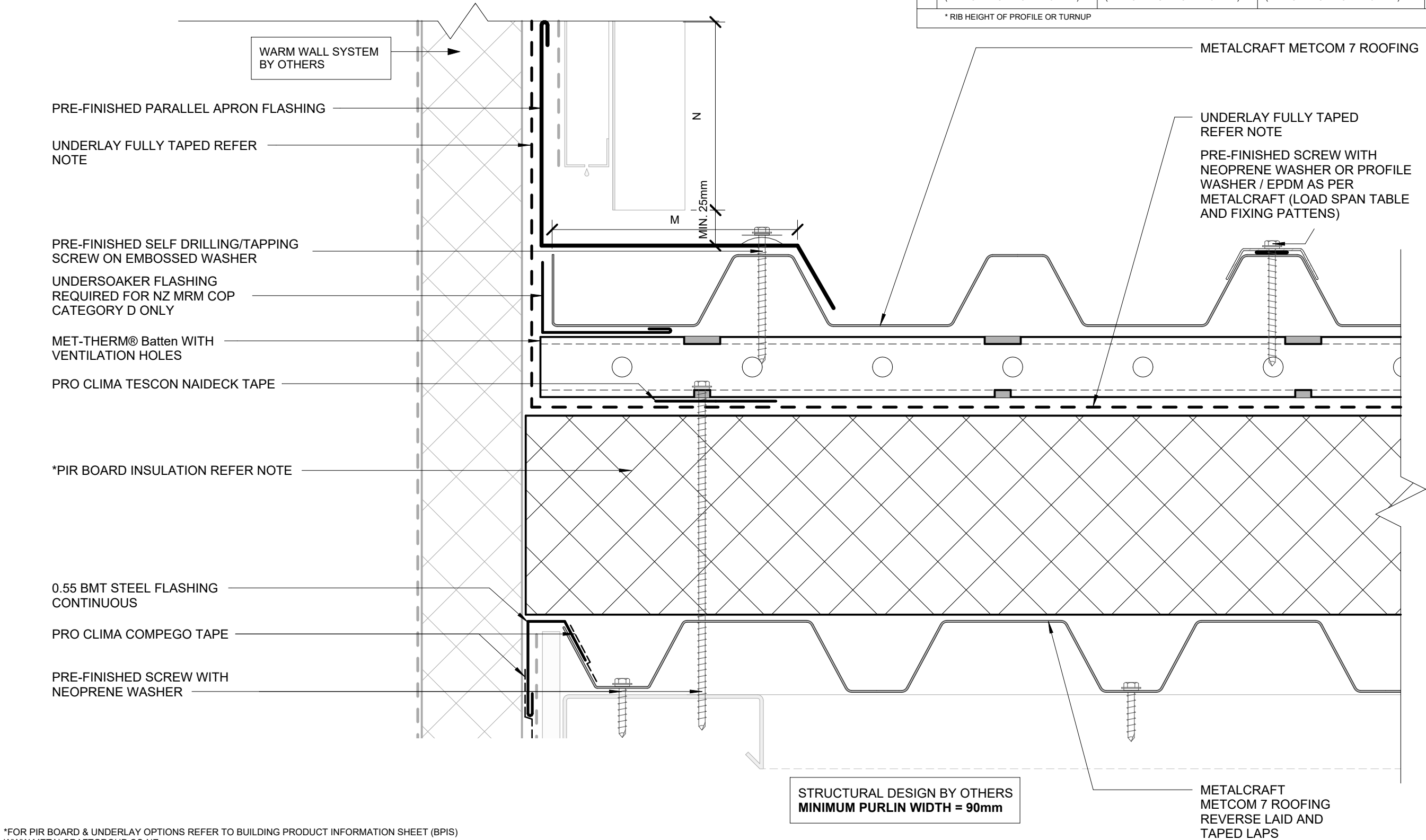

*FOR PIR BOARD & UNDERLAY OPTIONS REFER TO BUILDING PRODUCT INFORMATION SHEET (BPIS)
WWW.METALCRAFTGROUP.CO.NZ

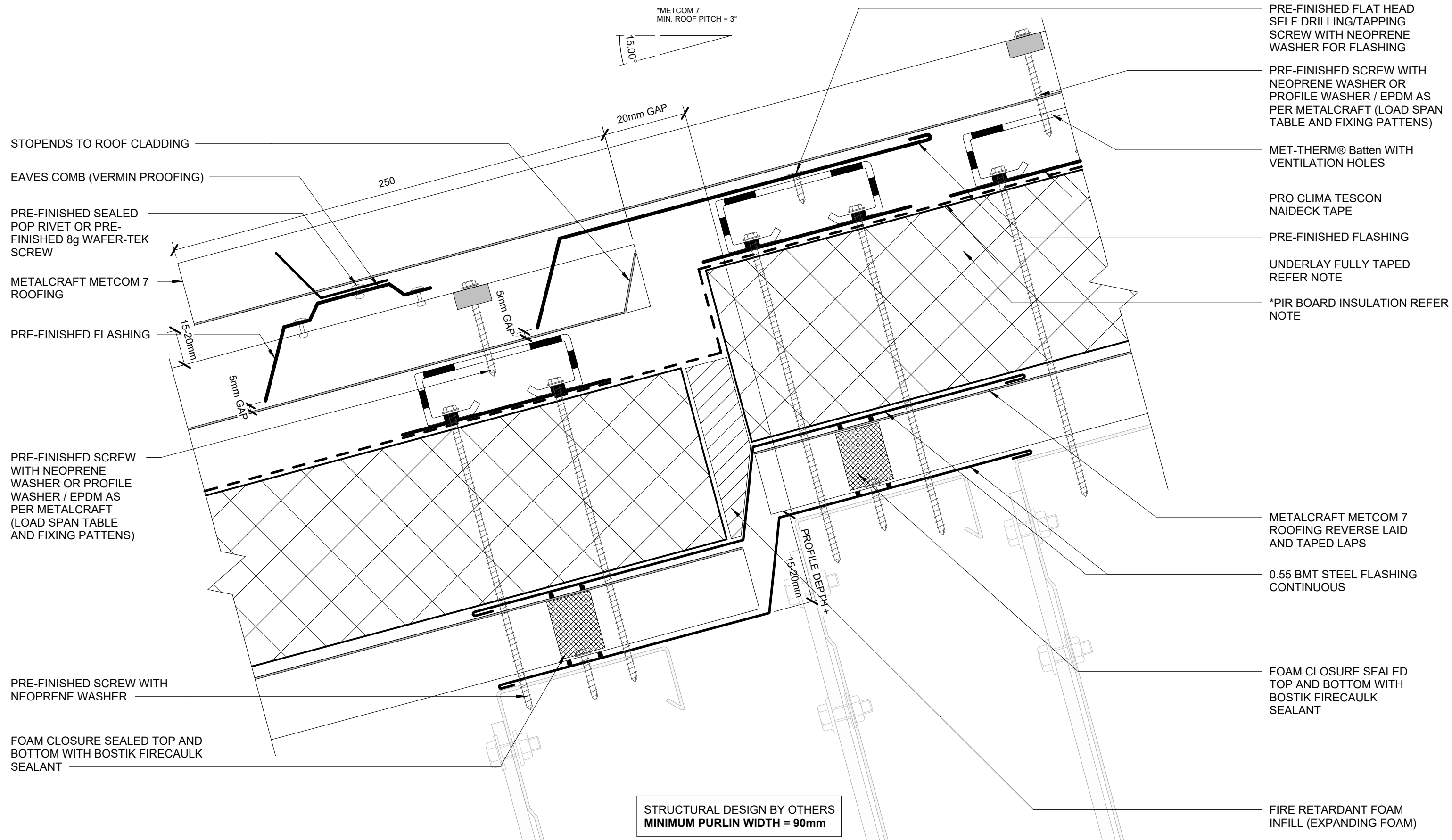

*FOR PIR BOARD & UNDERLAY OPTIONS REFER TO BUILDING PRODUCT INFORMATION SHEET (BPIS)
WWW.METALCRAFTGROUP.CO.NZ

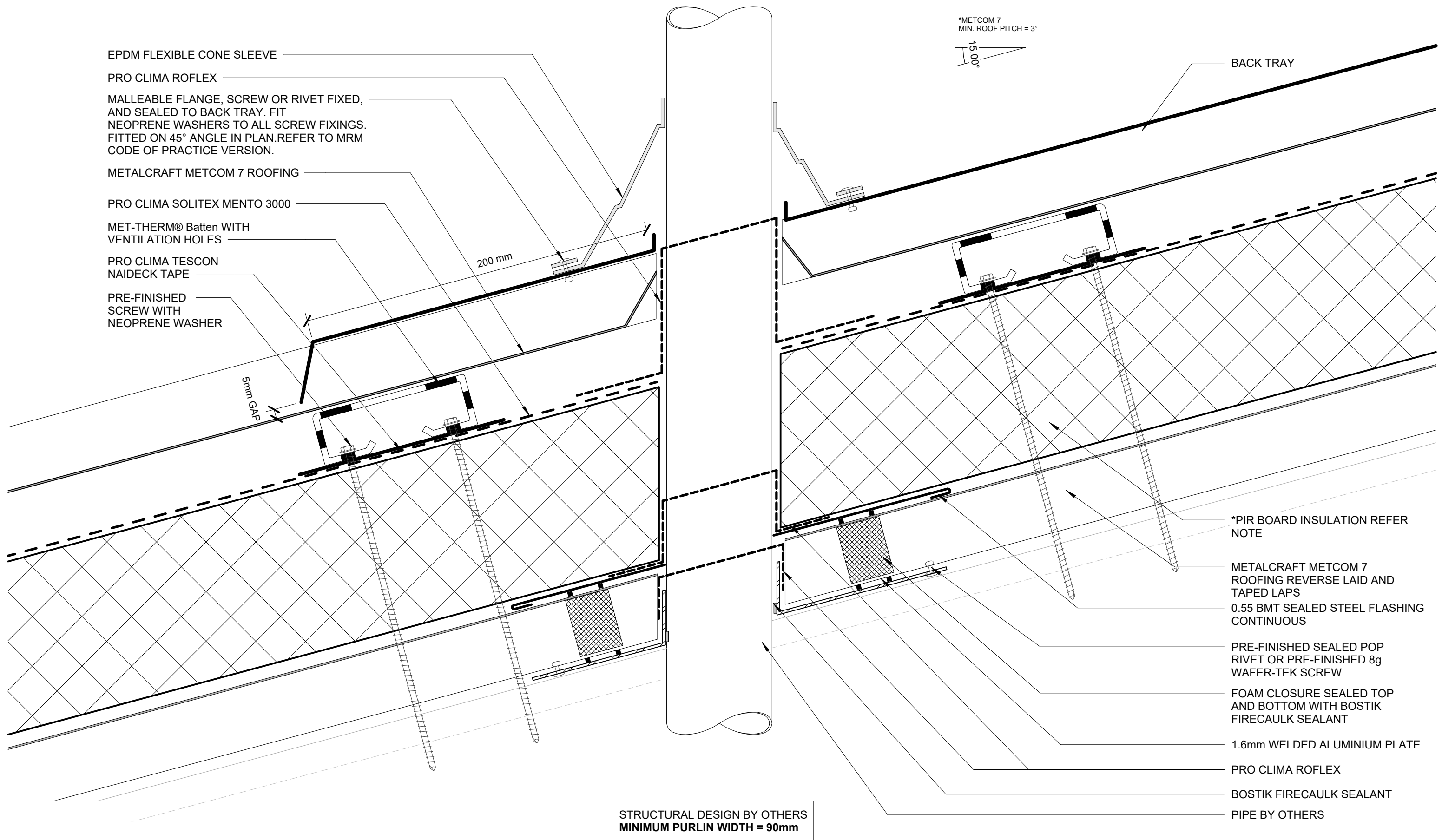

*FOR PIR BOARD & UNDERLAY OPTIONS REFER TO BUILDING PRODUCT INFORMATION SHEET (BPIS)
WWW.METALCRAFTGROUP.CO.NZ

Metalcraft
Roofing
www.metalcraftgroup.co.nz

DISCLAIMER:
These drawings are the copyright of Metalcraft Roofing and all details are to be used for indicative purposes only. The Architect / Designer should consult all of Metalcraft Roofing's MET-THERM® product literature and also the NZMRM code of practice and all relevant building codes. The Architect/ Designer must satisfy themselves that the chosen MET-THERM® system and relevant details are suitable for their specific project. Metalcraft Roofing reserves the right to alter or upgrade these details at any time without prior notice.

Met-Therm™ - Metcom 7

Rev. 1.0

COLD PIPE PENETRATION
WARM ROOFING DETAILS

Reference CRMTPMC7

Date OCT 2024

Scale 1 : 2

Sheet **D 10 / 13**

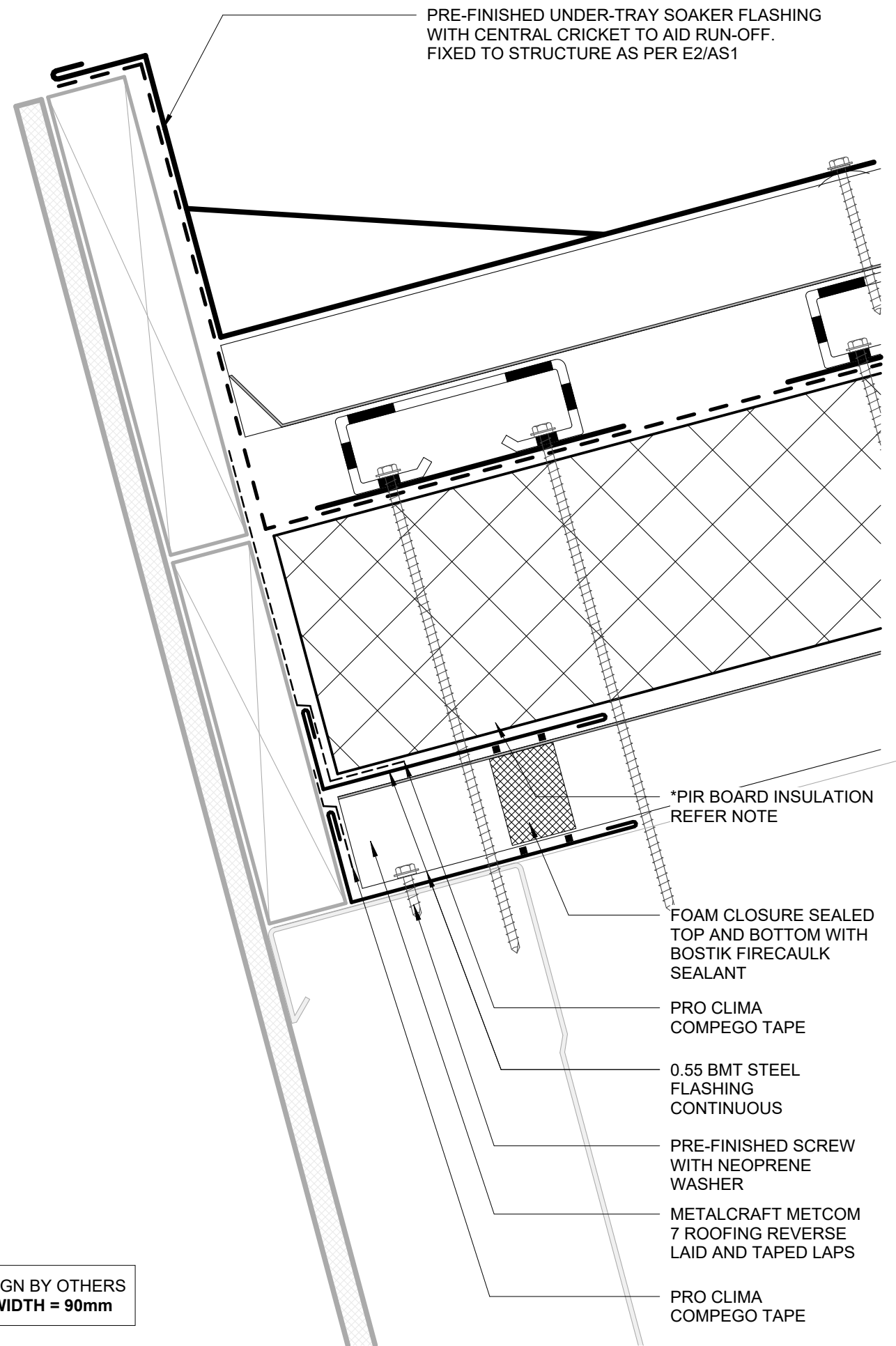
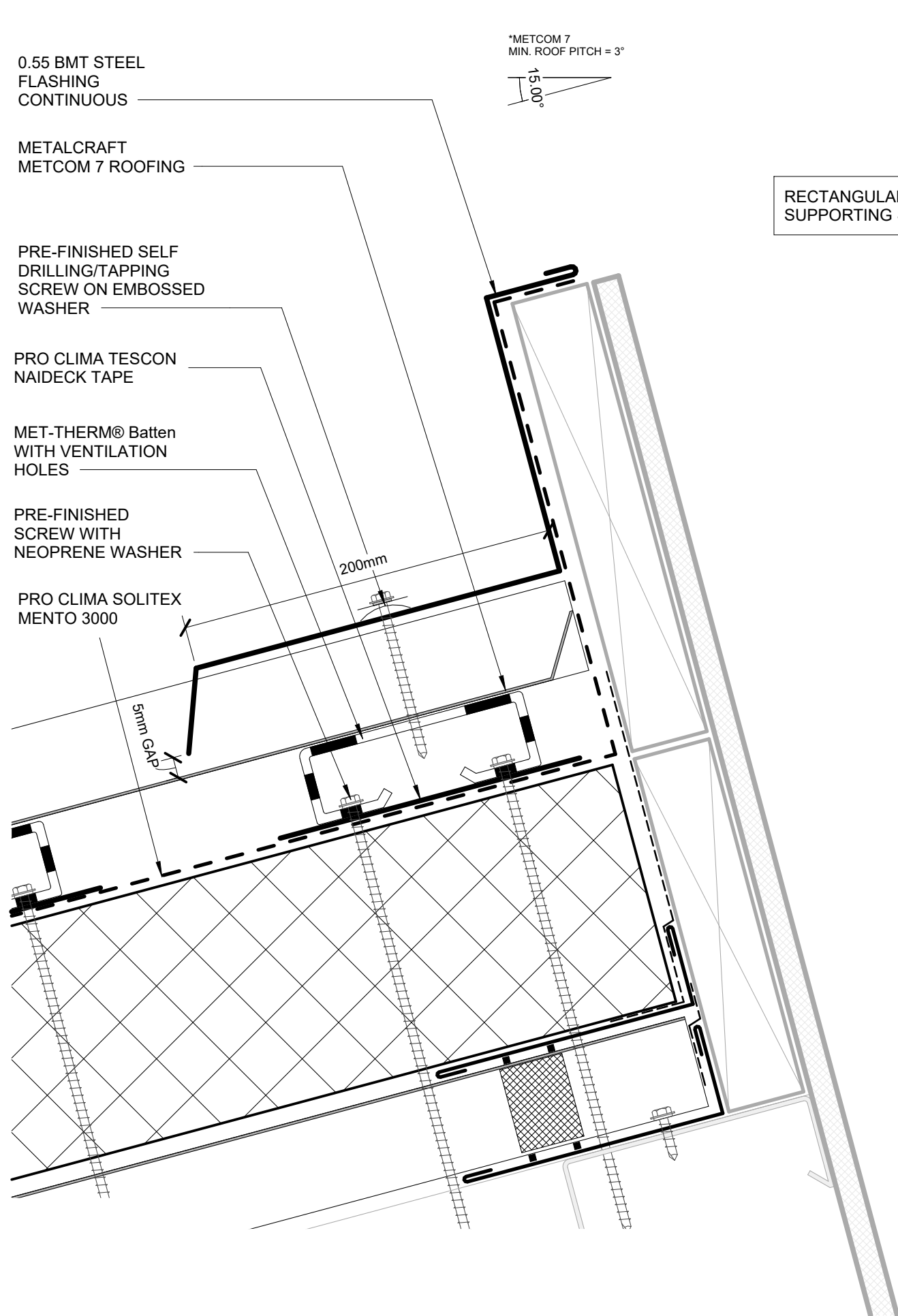

0.55 BMT STEEL FLASHING
CONTINUOUS

METALCRAFT METCOM 7
ROOFING

PRO CLIMA SOLITEX MENTO
3000

MET-THERM® Batten WITH
VENTILATION HOLES

PRO CLIMA TESCON
NAIDECK TAPE

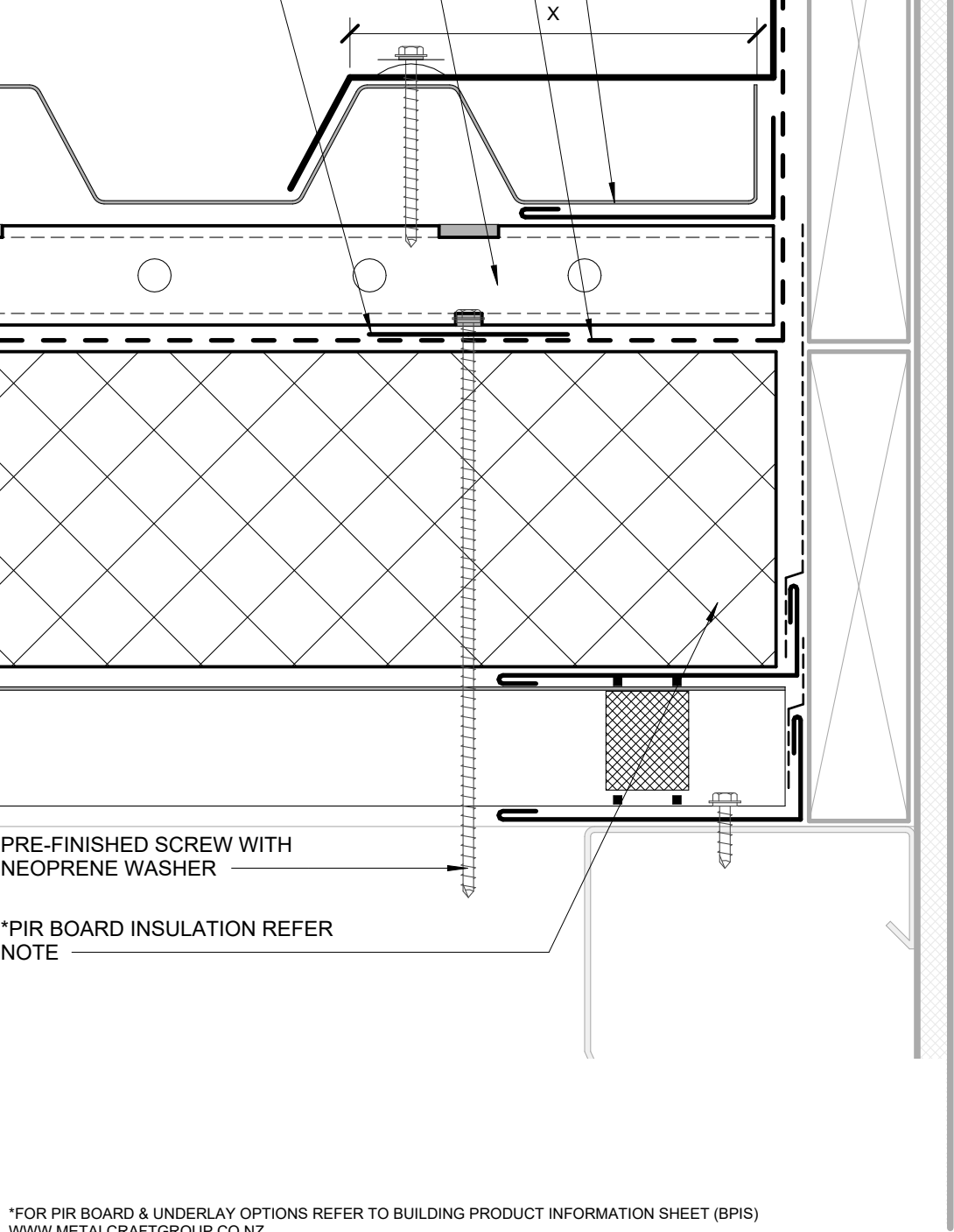

PRE-FINISHED SCREW WITH
NEOPRENE WASHER

*PIR BOARD INSULATION REFER
NOTE

*FOR PIR BOARD & UNDERLAY OPTIONS REFER TO BUILDING PRODUCT INFORMATION SHEET (BPIS)
WWW.METALCRAFTGROUP.CO.NZ

DISCLAIMER:
These drawings are the copyright of Metalcraft Roofing and all details are to be used for indicative purposes only. The Architect / Designer should consult all of Metalcraft Roofing's MET-THERM® product literature and also the NZMRM code of practice and all relevant building codes. The Architect/ Designer must satisfy themselves that the chosen MET-THERM® system and relevant details are suitable for their specific project. Metalcraft Roofing reserves the right to alter or upgrade these details at any time without prior notice.

RECTANGULAR AND SQUARE SKYLIGHT AND
SUPPORTING STRUCTURE BY OTHERS

AS PER MRM CODE OF PRACTICE	
CATEGORY A LOW, MEDIUM OR HIGH WIND ZONES - ALL ROOF PITCHES VERY HIGH AND EXTRA HIGH WIND ZONES WHERE THE PITCH IS EQUAL TO OR GREATER THAN 10° X TRAPEZOIDAL & TRAY: ONE RIB CORRUGATE: 2 CORRUGATIONS	CATEGORY B VERY HIGH WIND ZONES ROOF PITCH <8° EXTRA HIGH WIND ZONES -ALL ROOF PITCHES TRAPEZOIDAL & TRAY: TWO RIBS (20mm - 34mm)* ONE RIB (>34mm)* CORRUGATE: 2 CORRUGATIONS
CATEGORY C SED WIND ZONES UP TO 60 m/s ALL ROOF PITCH X TRAPEZOIDAL & TRAY: TWO RIBS (20mm - 34mm)* ONE RIB (>34mm)* CORRUGATE: 3 CORRUGATIONS	CATEGORY D SED WIND ZONES UP TO 68 m/s ALL ROOF PITCH TRAPEZOIDAL & TRAY: TWO RIBS (20mm - 34mm)* + UNDERSOAKER ONE RIB (>34mm)* + UNDERSOAKER CORRUGATE: 2 CORRUGATIONS + UNDERSOAKER
* RIB HEIGHT OF PROFILE OR TURNUP	

STRUCTURAL DESIGN BY OTHERS
MINIMUM PURLIN WIDTH = 90mm

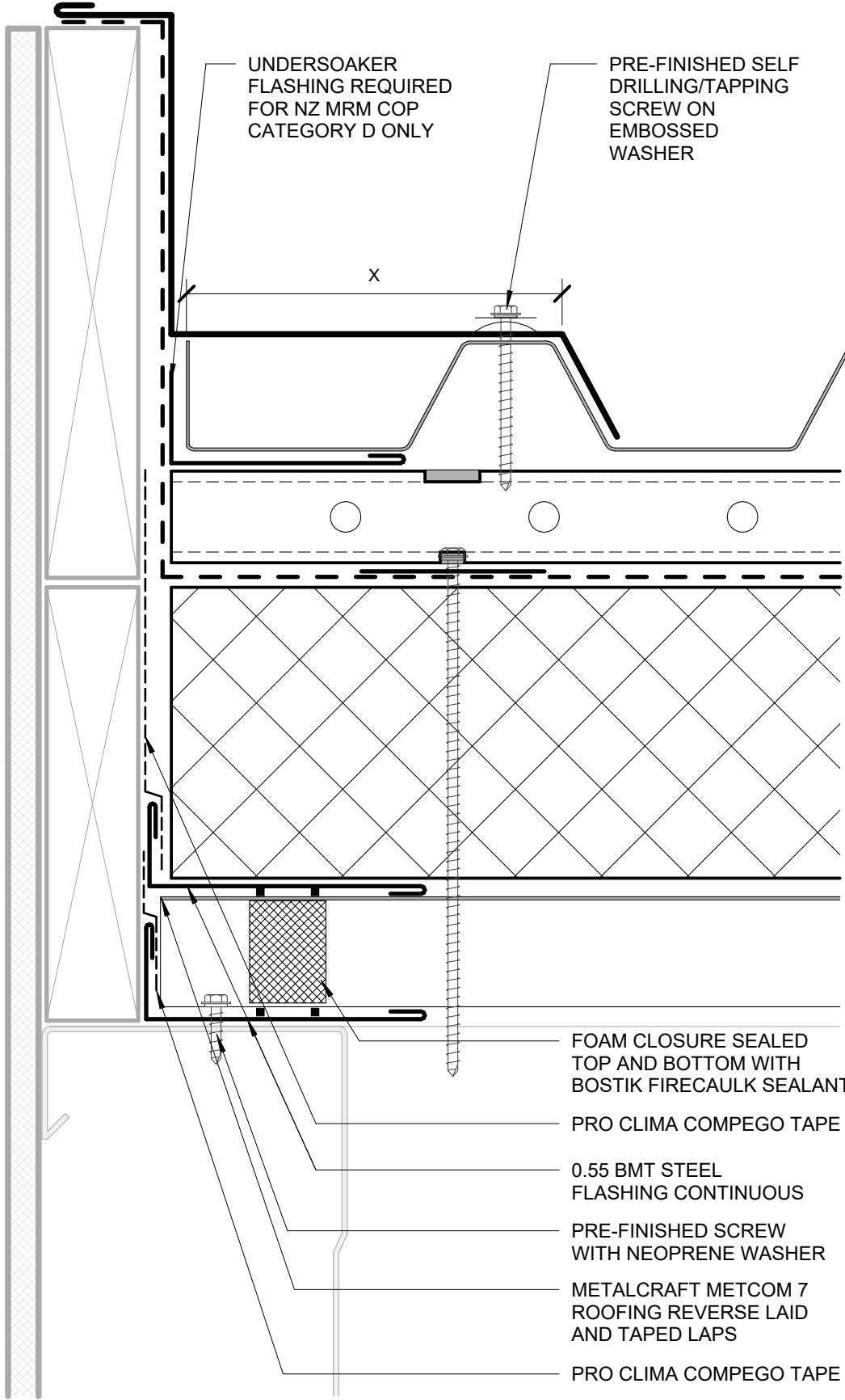

UNDERSOAKER
FLASHING REQUIRED
FOR NZ MRM COP
CATEGORY D ONLY

PRE-FINISHED SELF
DRILLING/TAPPING
SCREW ON
EMBOSSED
WASHER

FOAM CLOSURE SEALED
TOP AND BOTTOM WITH
BOSTIK FIRECAULK SEALANT

PRO CLIMA COMPEGO TAPE

0.55 BMT STEEL
FLASHING CONTINUOUS

PRE-FINISHED SCREW
WITH NEOPRENE WASHER

METALCRAFT METCOM 7
ROOFING REVERSE LAID
AND TAPED LAPS

PRO CLIMA COMPEGO TAPE

SKYLIGHT PENETRATION 02
WARM ROOFING DETAILS

PRE-FINISHED SCREW WITH
NEOPRENE WASHER OR PROFILE
WASHER / EPDM AS PER METALCRAFT
(LOAD SPAN TABLE AND FIXING
PATTERNS)

METALCRAFT METCOM 7
ROOFING

MET-THERM® Batten WITH
VENTILATION HOLES

PRO CLIMA SOLITEX MENTO
3000

PRE-FINISHED SCREW WITH
NEOPRENE WASHER

PRO CLIMA COMPEGO TAPE

*PIR BOARD INSULATION REFER
NOTE

METALCRAFT METCOM 7
ROOFING REVERSE LAID AND
TAPED LAPS

PRE-FINISHED SCREW WITH
NEOPRENE WASHER

STRUCTURAL DESIGN BY OTHERS
MINIMUM PURLIN WIDTH = 90mm

PRE-FINISHED SCREW WITH
NEOPRENE WASHER OR PROFILE
WASHER / EPDM AS PER METALCRAFT
(LOAD SPAN TABLE AND FIXING
PATTERNS)

METALCRAFT METCOM 7
ROOFING

MET-THERM® Batten WITH
VENTILATION HOLES

*PIR BOARD INSULATION REFER
NOTE

METALCRAFT METCOM 7
ROOFING REVERSE LAID AND
TAPED LAPS

PRO CLIMA COMPEGO TAPE

STRUCTURAL DESIGN BY OTHERS

PRE-FINISHED SCREW WITH
NEOPRENE WASHER

*FOR PIR BOARD & UNDERLAY OPTIONS REFER TO BUILDING PRODUCT INFORMATION SHEET (BPIS)
WWW.METALCRAFTGROUP.CO.NZ